

Visit [www.bakugan.com](http://www.bakugan.com) to experience the new and expanded rules!  
 Pour connaître les nouvelles règles du jeu de la saison 2, visitez [www.bakugan.com](http://www.bakugan.com) !

© 2009 Sega Toys/Spin Master Ltd. Bakugan ®/MD and related trademarks are property of Spin Master Ltd. All rights reserved.  
 © 2009 Sega Toys/Spin Master Ltd. Bakugan ®/MD et les marques de commerce qui y sont associées sont la propriété de Spin Master Ltd.  
 Tous droits réservés.

SPIN MASTER LTD., 450 FRONT STREET WEST, TORONTO, ON M5V 1B6 CANADA.  
 Spin Master, Inc., PMB #10035, 300 International Drive, Suite 100, Williamsville, NY 14221.  
 Spin Master Toys Far East Limited, RM #1113, 1/F, Chinschem Golden Plaza, 77 Mody Rd., Tsimshatsui E., Kowloon, HK.  
 Spin Master Toys UK Ltd., Meadowbank, Furlong Road, Bourne End, Bucks, SL8 5AJ, United Kingdom.  
 Customer Service: 0870 850 8408 Email: [ukservice@spinmaster.com](mailto:ukservice@spinmaster.com).  
 Spin Master France - 36 rue de Billy-02100 Boulogne-Billancourt - France.  
 Customer Service: Numéro vert / France: 0800 803 355  
 ou E-mail: [Jouets@spinmaster.com](mailto:Jouets@spinmaster.com) Site internet: [www.spinmaster.fr](http://www.spinmaster.fr)  
 Customer Care / Service clientèle: 1-800-622-8339  
[www.spinmaster.com/customercare](http://www.spinmaster.com/customercare)

Conforms to product safety standards ASTM F963, EN71 regulatory requirements. PRODUCT AND COLORS MAY VARY. Please retain this information for future reference. Please remove all packing material before giving to children. MADE IN CHINA. PATENT PENDING.

Conforme aux normes de sécurité des produits ASTM F963, et EN71. LE PRODUIT ET LES COULEURS PEUVENT VARIER. Conservez ces renseignements pour consultation ultérieure. Enlevez tout l'emballage avant de donner ce jouet à des enfants. FABRIQUÉ EN CHINE. BREVET EN INSTANCE.

[www.bakugan.com](http://www.bakugan.com)

Warning! Small parts and small balls.  
 Avertissement! Des petites pièces et petites billes.

CE

430002783\_GBL\_ENG\_REV 0  
 T00000\_0006\_20002783\_GBL\_JIS

SEGA TOYS

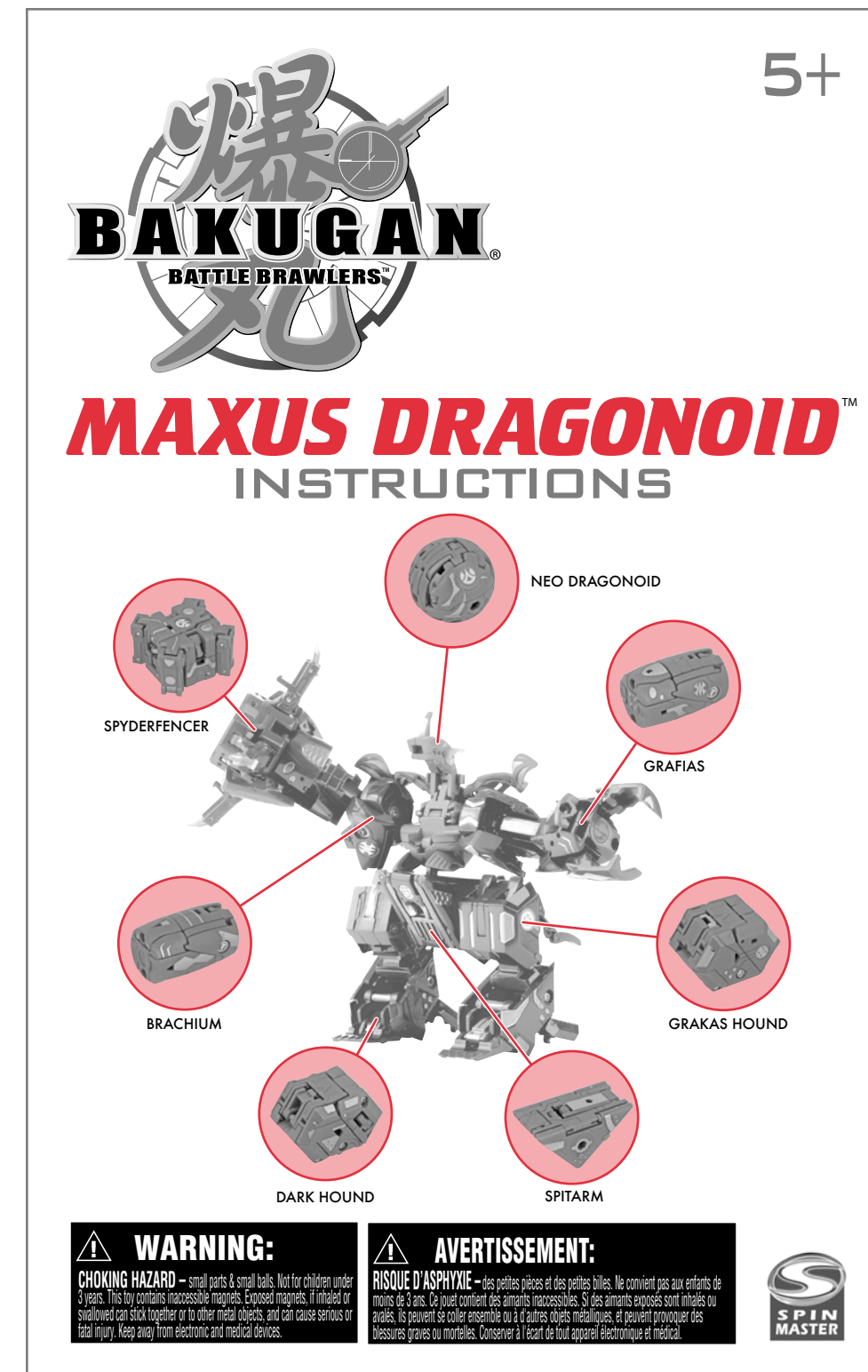

5

Back Cover 6

Cover 1

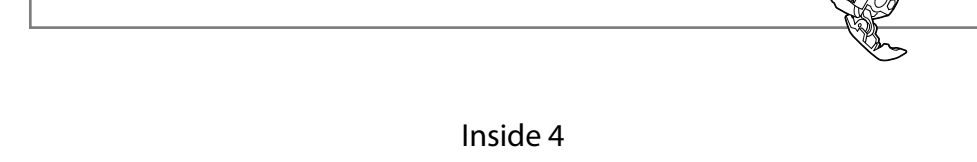
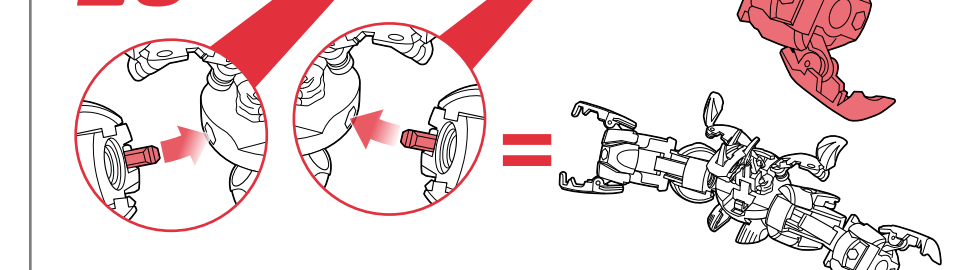
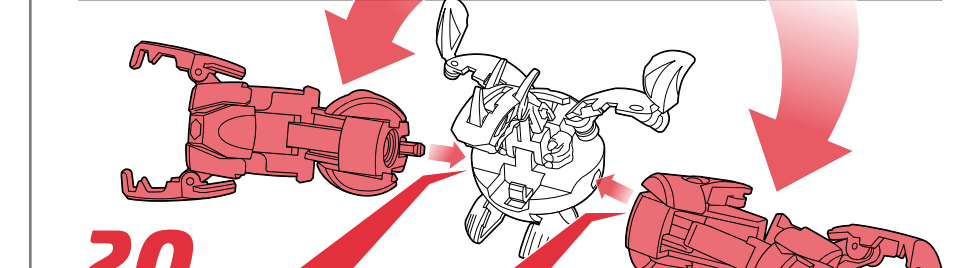
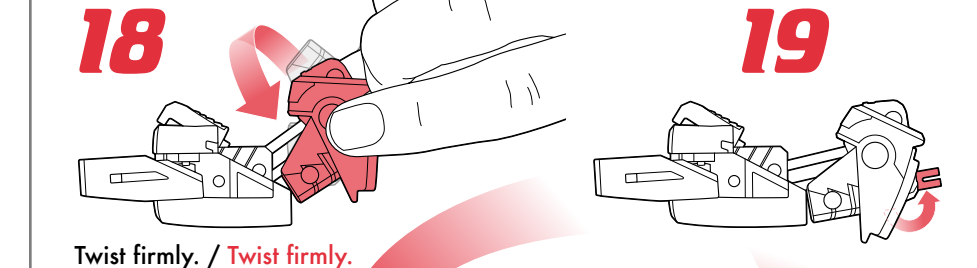
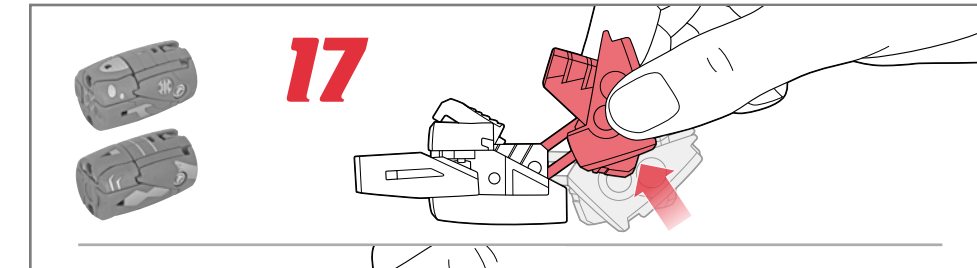
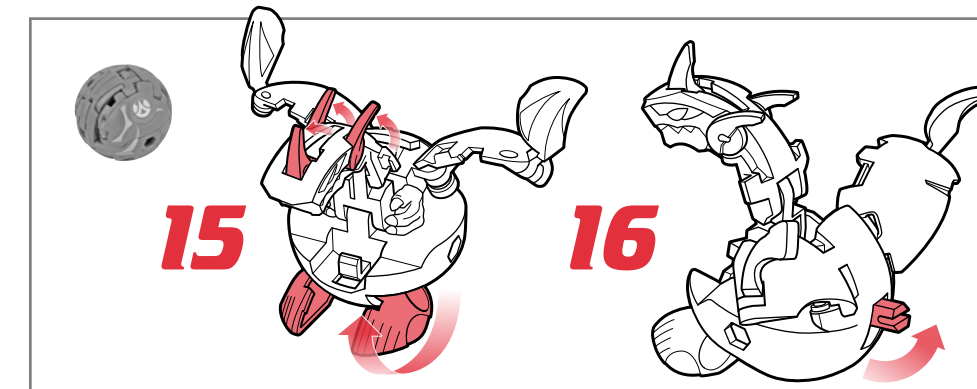
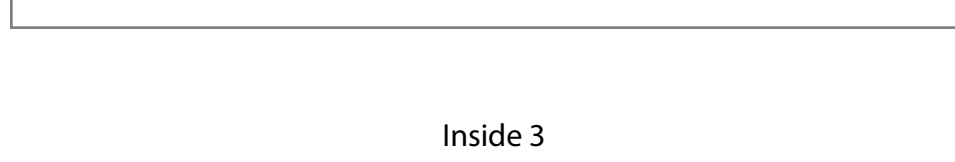
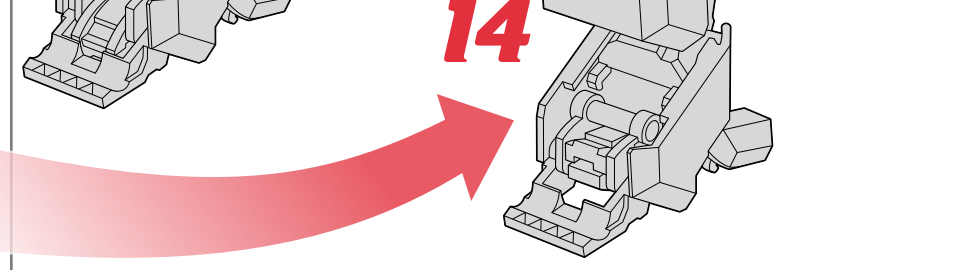
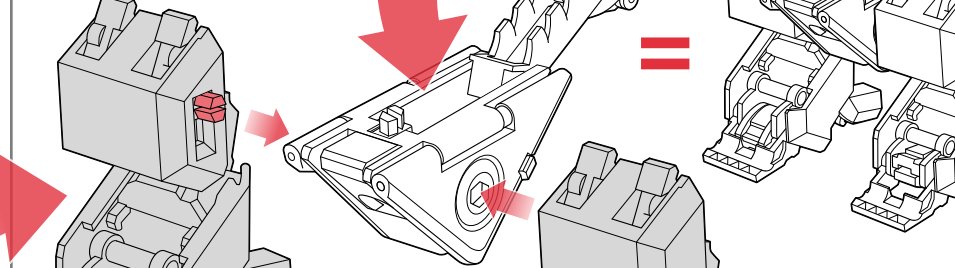
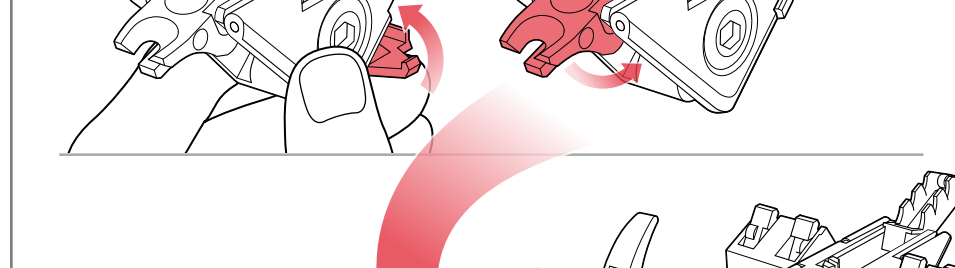
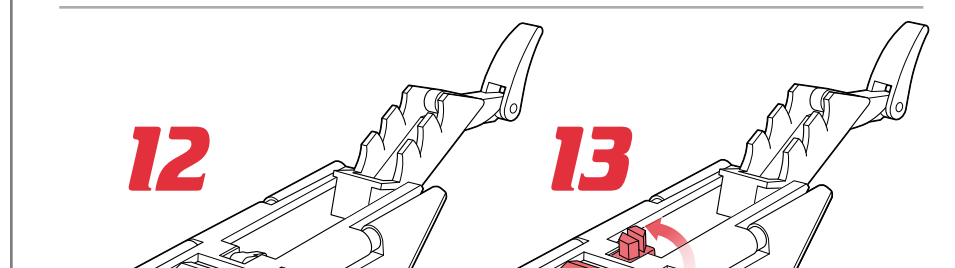
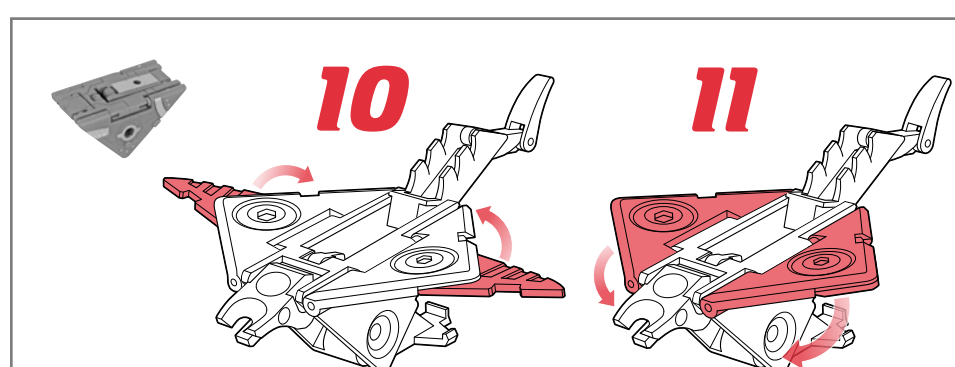
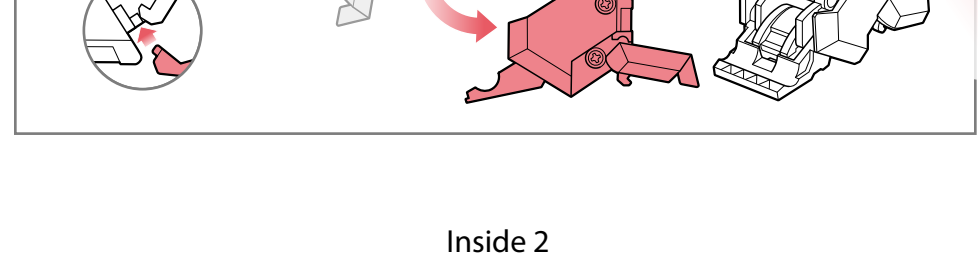
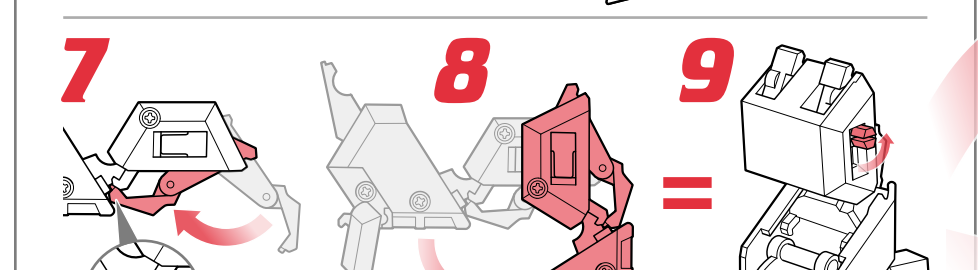
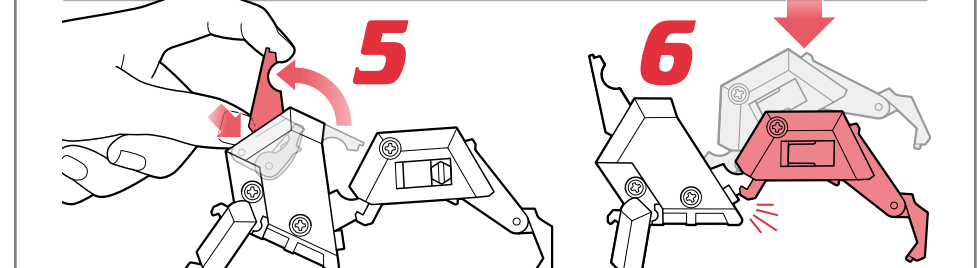
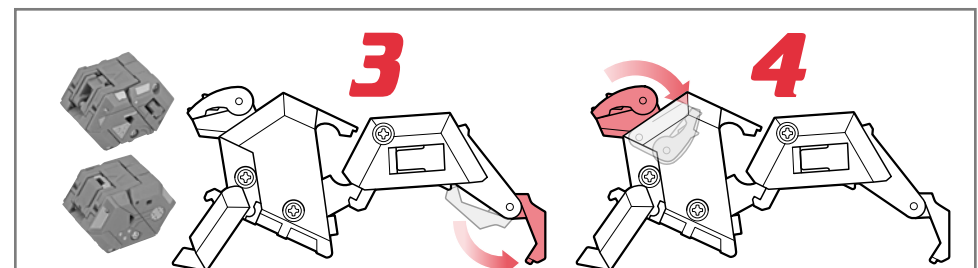
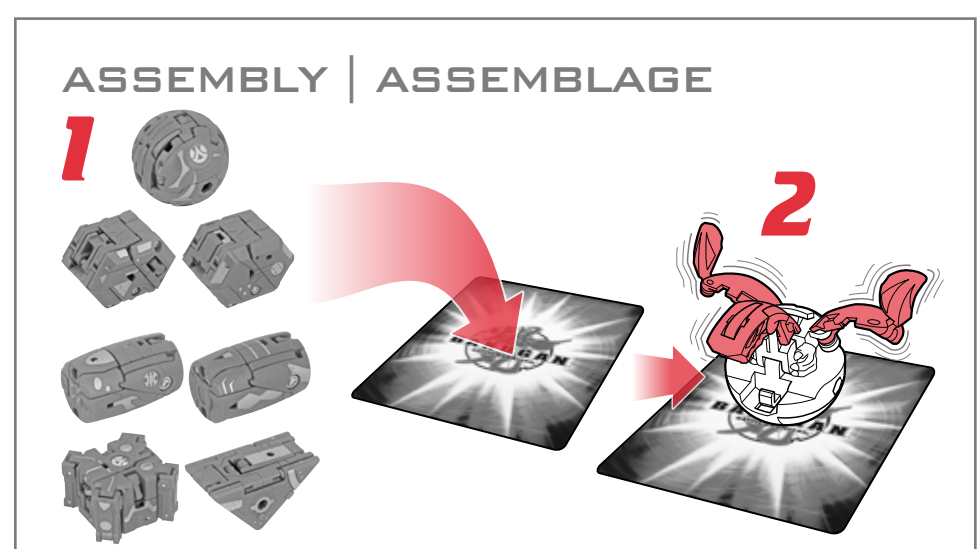

Inside 2

Inside 3

Inside 4